

## MF 70.1 L PLUS<sup>or</sup> EQUAL

REACH-IN Blast Chiller and Shock Freezer



MultiFresh®: the multi-function assistant that will organize your production and processes with flexibility 24 hours a day. MultiFresh is the first and only machine in the world that can run operating cycles with temperatures from 185°F to -40°F preserving its consistency, moisture content, and nutritional properties. Multifunction 7" touchscreen display, product specific cycles, wide range of options, customization of all the parameters for each cycle.

### Capacity

(18"x26") sheet pans (12)

(12"x20") steam table pans (24)

### Yield

Blast chilling capacity (194/+37°F) 154 Lbs.

Shock freezing capacity (194/-0°F) 154 Lbs.

### Product Warranty Protection

- 2 years, parts and labor
- 5 years, compressor

### Certification



### Standard Construction Features

- (6) stainless steel wire shelves
- All type 304 stainless steel construction
- CFC-free high-density polyurethane insulation
- Full width door with low-temperature resistant magnetic gasket
- Irinox Patented die-stamped interior door liner to magnetically store core temperature probe
- MultiSensor® 5-point probe for perfect temperature control.
- Automatic switch from manual mode (timed) to automatic mode (with probe) when probe is not inserted
- Removable stainless steel pan supports, adjustable spacing
- Approved 404a refrigerant used in sealed system
- High efficiency evaporators with multiple injection points
- Data port & Wi-Fi capable data transfer to HACCP software
- Door hinged left (standard)
- 6" stainless steel adjustable legs
- End-of-cycle hold mode
- Self-contained, air-cooled energy efficient condensing unit
- Manual defrosting required at the end of the day
- SANIGEN sanitation system
- Power cord included (no plug)

### Unique Design and Performance Features

- Available heat cycles: THAWING, HOLDING (hot or cold), REGENERATION, PASTEURIZATION, PROOFING, LOW TEMPERATURE COOKING.
- Indirect air distribution and special airflow pattern to ensure perfect temperature uniformity
- Adjustable MULTIRACK® tray holder, which allows operators to double the quantity of trays loaded in each model.
- MultiFresh® touch screen
- Easily accessible evaporators, waterproof fans and removable magnetic condenser filter.
- Core probe magnetically secured to door when not in use

### Options and Accessories

- Door hinged Right
- 4 swivel casters (2 with locks)
- Sous-vide core probe
- Additional core probe
- Additional wire shelves
- Water cooled remote condensing unit
- Air cooled remote condensing unit

## Cabinet

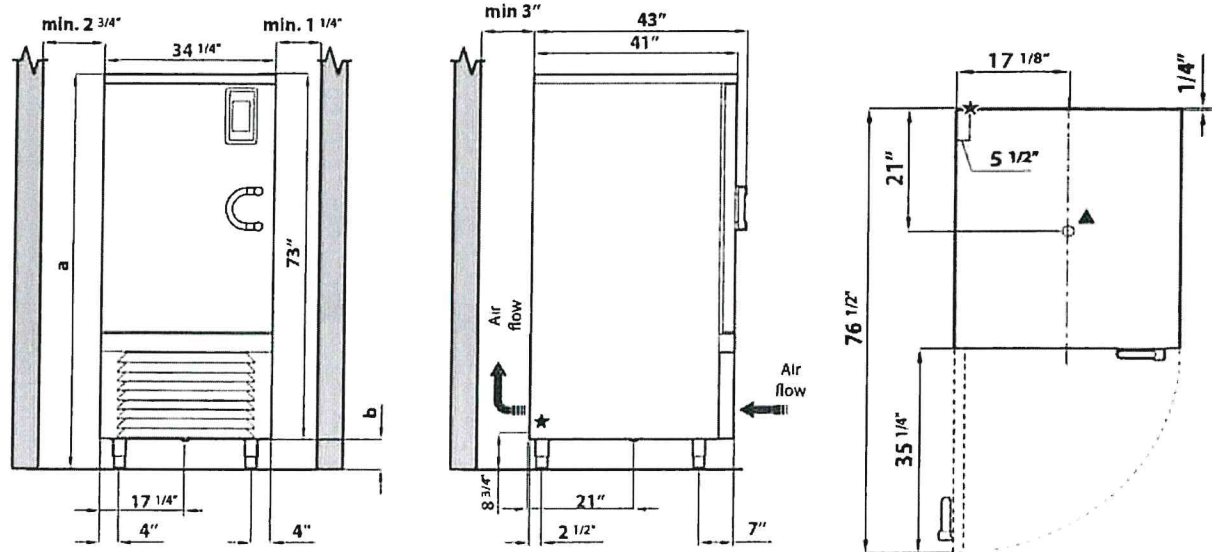

★ Main power cable  
▲ Drain pipe  $\varnothing 31$

	<b>Cabinet</b>
	34 1/4"
<b>Depth</b>	43"
<b>Height w/legs not extended</b>	79"
<b>Height w/casters</b>	79 1/7"
<b>Weight</b>	742 Lbs.

<b>Electric Data / Power Requirements</b>	
Electric Supply	208V 60 Hz 3 Phase
Full load amps	26,80 A
Total Rating (FLI)	6,70 kW
Main power cable	AWG 4G11

<b>Key Refrigeration System Data</b>	
Compressor Rating (HP)	4,0
Refrigeration Yield (14/104°F) btu/h	35140
Condensing Rating (14/104°F) btu/h	53019
Refrigeration Type	R404A
Maximum Ambient Air Temperature	90°F

### INSTALLATION NOTES

Compressor requires 4" minimum rear wall clearance or 3" right and left clearance

Continued product development may require specification changes without prior notice.